

# LOS OSOS LIBRARY



**SITE PLAN**  
Scale: 1/16" = 1'-0"



# LOS OSOS LIBRARY

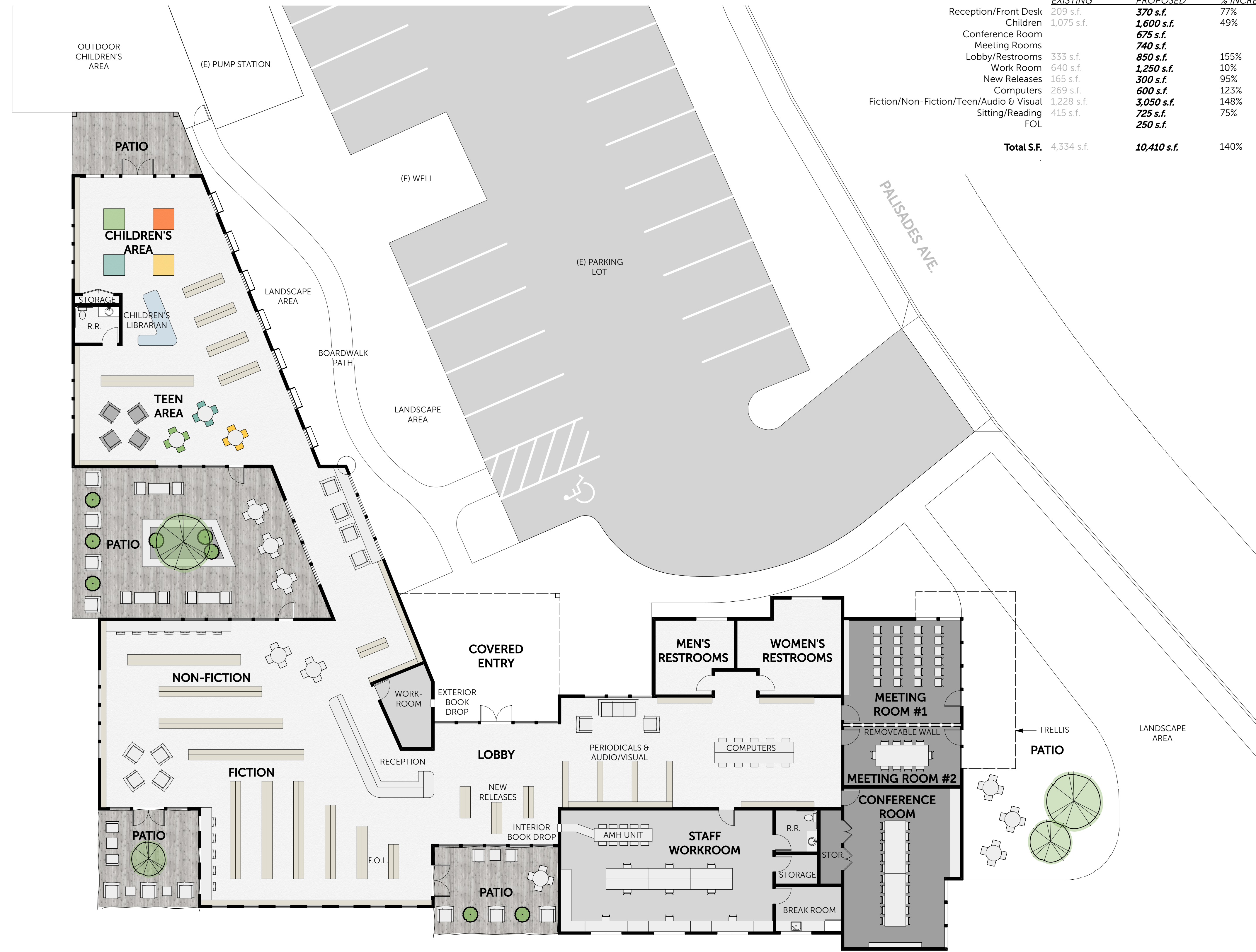

## PROGRAM

	EXISTING	PROPOSED	% INCREASE
Reception/Front Desk	209 s.f.	<b>370 s.f.</b>	77%
Children	1,075 s.f.	<b>1,600 s.f.</b>	49%
Conference Room		<b>675 s.f.</b>	
Meeting Rooms		<b>740 s.f.</b>	
Lobby/Restrooms	333 s.f.	<b>850 s.f.</b>	155%
Work Room	640 s.f.	<b>1,250 s.f.</b>	10%
New Releases	165 s.f.	<b>300 s.f.</b>	95%
Computers	269 s.f.	<b>600 s.f.</b>	123%
Fiction/Non-Fiction/Teen/Audio & Visual	1,228 s.f.	<b>3,050 s.f.</b>	148%
Sitting/Reading	415 s.f.	<b>725 s.f.</b>	75%
FOL		<b>250 s.f.</b>	
<b>Total S.F.</b>	<b>4,334 s.f.</b>	<b>10,410 s.f.</b>	<b>140%</b>



LOS OSOS LIBRARY



VIEW 1



LOS OSOS LIBRARY

**REISS**  
DESIGN STUDIO, PC

August 16, 2021



VIEW 2